

A Breakthrough Tile Solution

Solar installs on tile roofs can be messy and complicated. These jobs often require tile grinding to ensure fit, a struggle to align mounting components, and extensive searches to find the replacements for broken tiles.

Knockout Tile is the solution. The replacement mount rapidly and reliably integrates into the existing roof system. With the strike of a hammer, you create a solid stack of high-performance, form-fitting components which fully encases the waterproof seal. The result? Unprecedented speed and flexibility during installation.



Form-Fit Waterproofing

Knockout Tile keeps water down and out with its unique compression seal technology formed by joining the flashing, gasket, and L-foot through a single strike of the hammer.

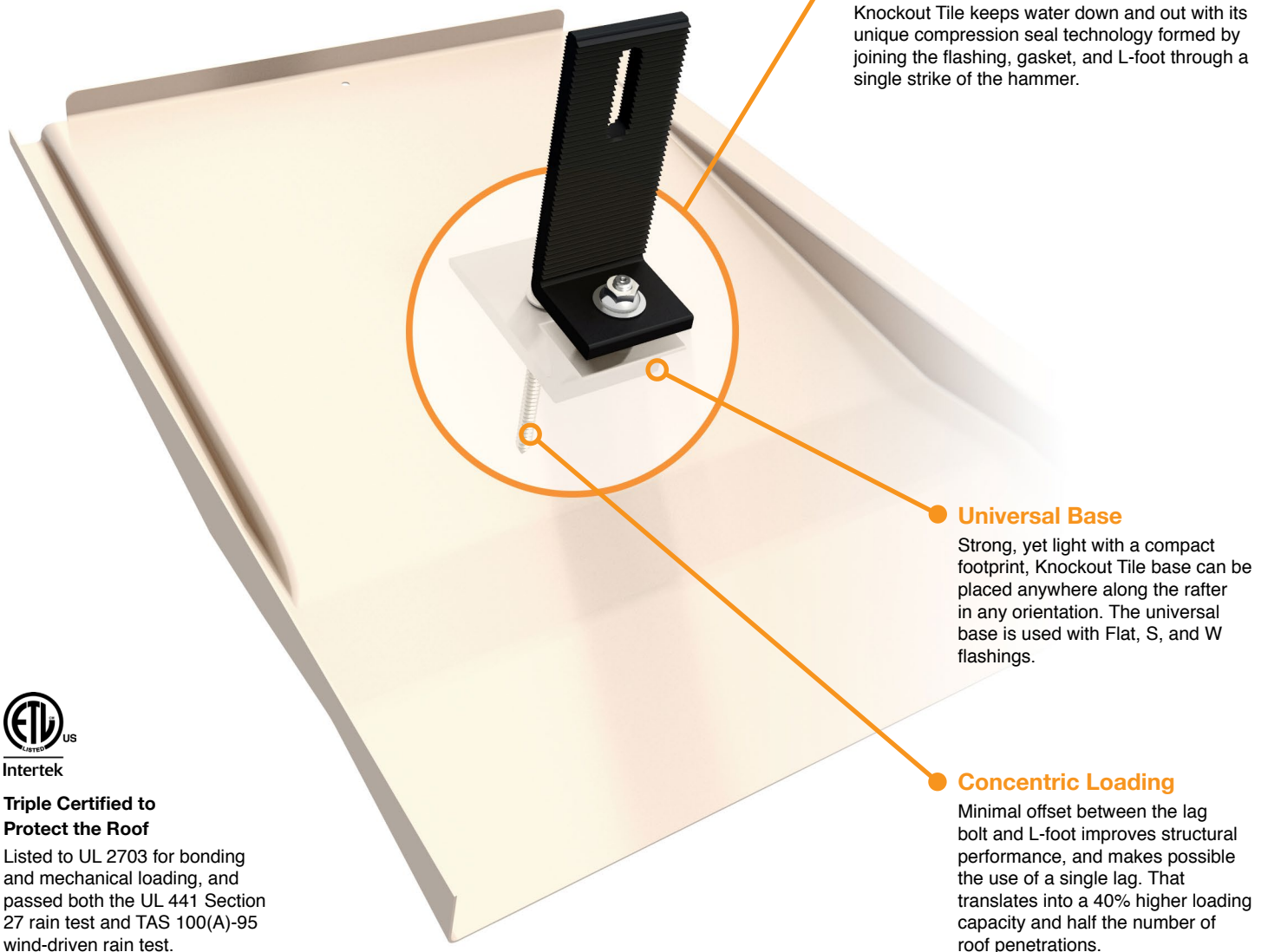

Universal Base

Strong, yet light with a compact footprint, Knockout Tile base can be placed anywhere along the rafter in any orientation. The universal base is used with Flat, S, and W flashings.

Concentric Loading

Minimal offset between the lag bolt and L-foot improves structural performance, and makes possible the use of a single lag. That translates into a 40% higher loading capacity and half the number of roof penetrations.



Intertek

Triple Certified to Protect the Roof

Listed to UL 2703 for bonding and mechanical loading, and passed both the UL 441 Section 27 rain test and TAS 100(A)-95 wind-driven rain test.

No Struggling to Align Components

Punch through the flashing anywhere in these zones.

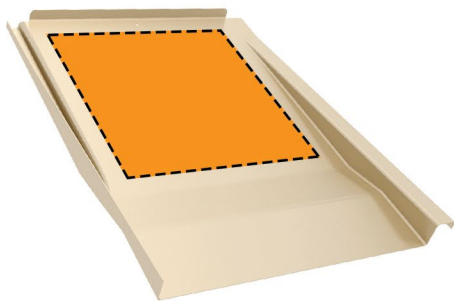

Flat Tile

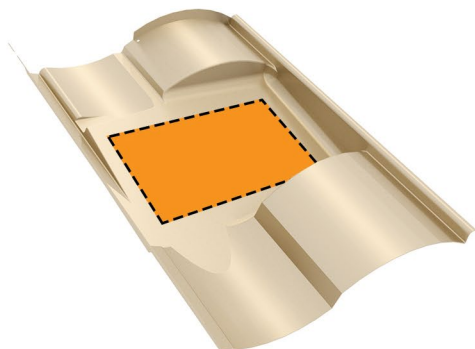

S-Tile

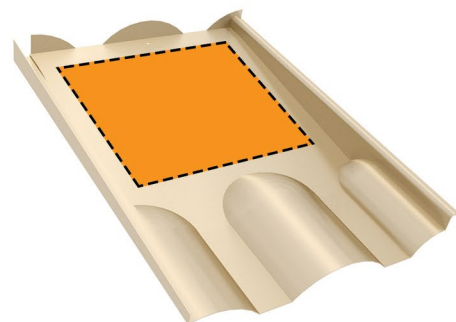

W-Tile

DENT IT

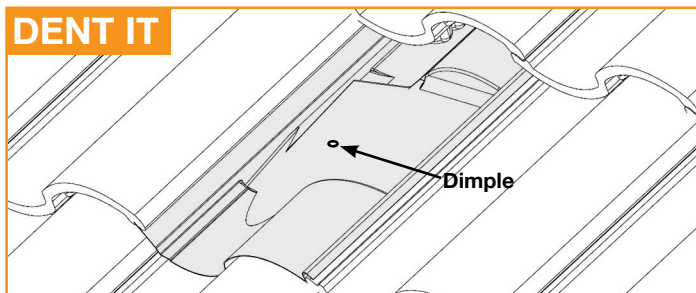

Deliver a Knockout in Record Time

Remove the tile and mark the rafter. Use the base as guide to drill 1/4" pilot hole and fill with roofing manufacturer's approved sealant.

STRIKE IT

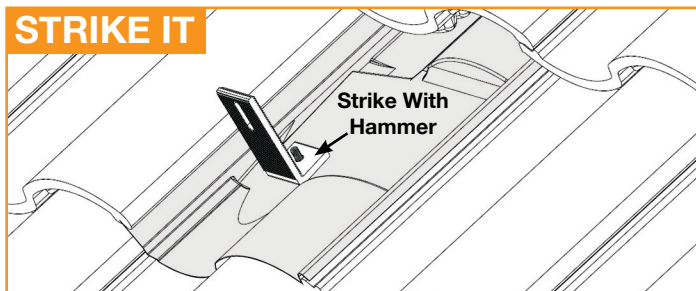

Insert the lag bolt with bonded washer through the base into the pilot hole. The base can be installed parallel or perpendicular to the rafter.

Press the Tile Replacement Flashing onto the base until a dent forms over the post. Form the edges of the flashing to quickly create a tight fit.

DRIVE IT

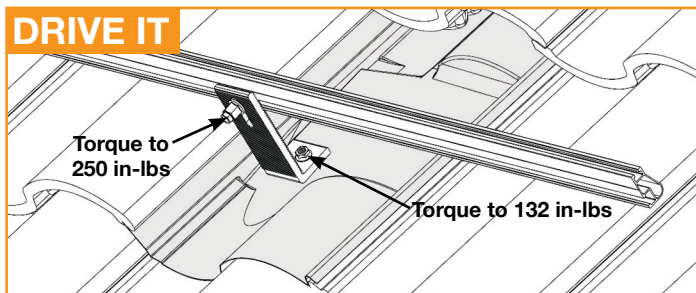

Place the L-Foot over the top of the dent and strike with the hammer to punch the threaded post through the flashing.

Once the L-Foot is positioned, torque the hardware to 132 in-lbs and attach the rail to either side of the L-Foot and torque hardware to 250 in-lbs.

25-Year Warranty

When using Knockout Tile with XR Rail, the entire assembly is covered by IronRidge's 25-year warranty. To learn more about IronRidge's product warranty, visit the IronRidge website at www.ironridge.com.