

Wi-Fi PlugPro

Quick Installation Guideline

MS-W-09



SmartESS(iOS)



SmartESS(Android)

1. Installation

- 1 Connect the 4PIN aviation of the Wi-Fi PlugPro to the power cable aviation side and tight it.
- 2 Connect the other side of power cable to the inverter.
- 3 Confirm the status of the LED indicator (After step2.3, when 4 LED indicators keep on, showing the normal working status).

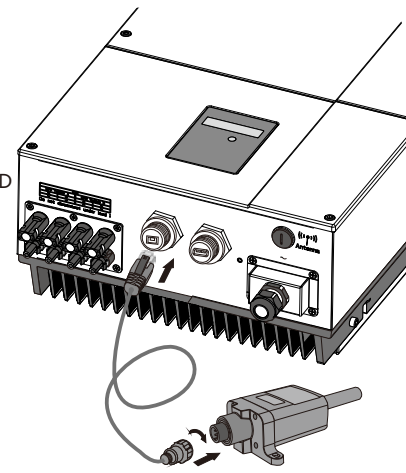
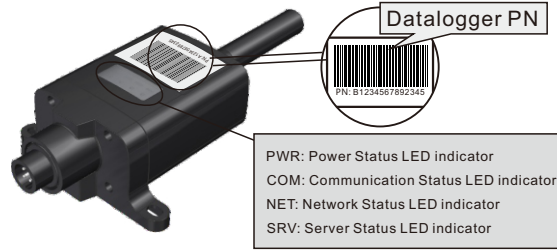

2. Wireless Router Connection

2.1 Download APP and Wi-Fi connection

- 1 Scan the QR Code from the cover of this guideline and download the APP.
- 2 Select the same number of Wi-Fi PlugPro PN to connect on your phone WLAN.
(Initial Password:12345678)

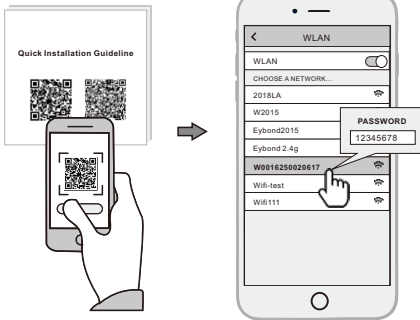

2.2 Wi-Fi Config

- 1 Open the APP, Tap the **Wi-Fi Config** button to enter this page.
- 2 Then tap the **Network Setting** button.

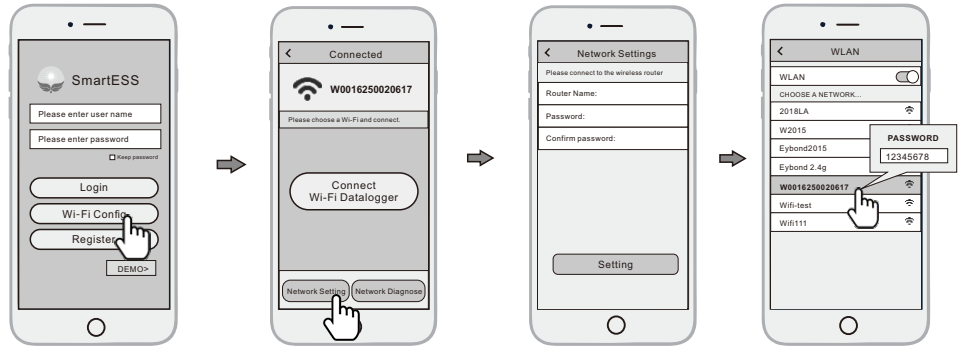

2.3 Network Setting

- 1 According to the prompts, type in the information to finish the network setting.
- 2 After the Wi-Fi PlugPro is restarted, reconnect the Wi-Fi which connected by step 2.1.

3. Create Account And Datalogger

3.1 Create Account

- 1 Open the APP, tap the **Register** button.
- 2 According to the prompt information, complete creating an account.

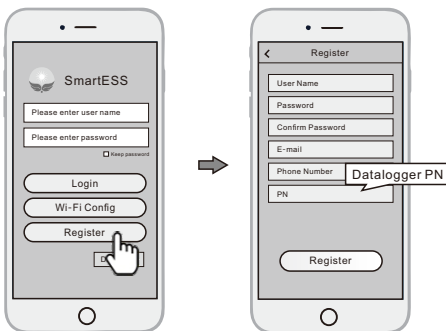

3.2 Add Datalogger

- 1 Login the account and click the list button on the bottom of the home page.
- 2 Tap the "+" button on the top-right corner of the list page.
- 3 Scan the datalogger PN on the Wi-Fi PlugPro, or input it manually.
- 4 According to the prompts, type in the information to finish add datalogger.

