

# RibBracket I

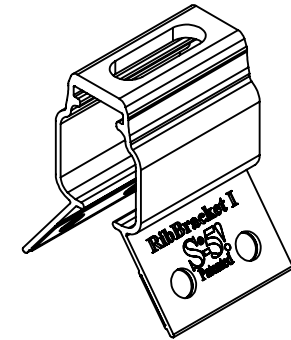

Slot for Hex Flange Nut

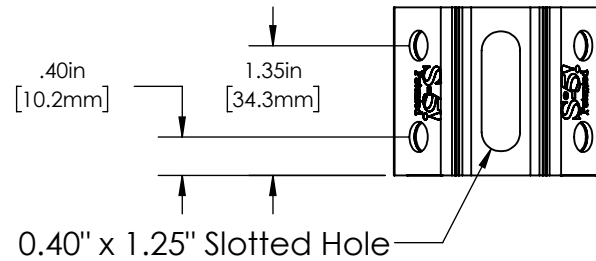
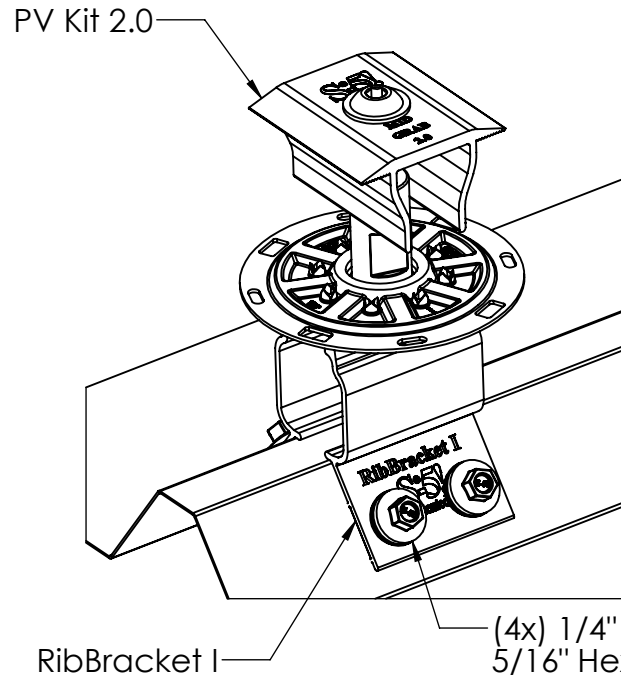
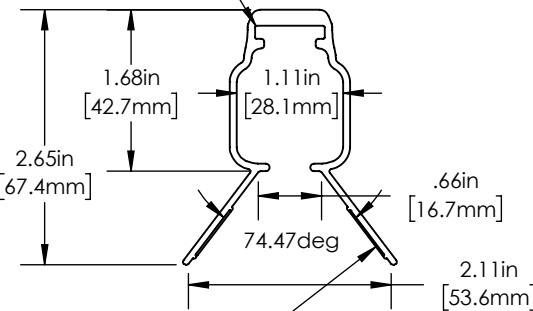

(2x) Factory Applied EPDM

(4x)  $\phi$ .31" Through Hole for Fasteners

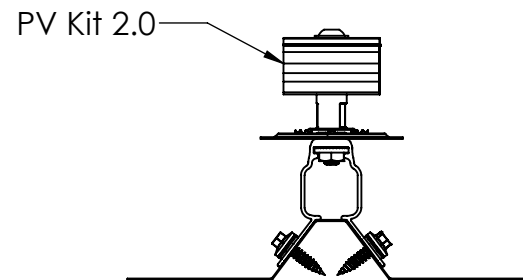
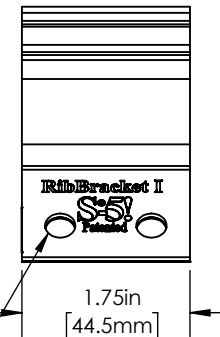

Designed to fit popular Hawaiian profiles such as HPM Custom 4-Rib, HPM Custom 6-Rib, and other similarly dimensioned profiles.

**FOR STANDING SEAM SPECIFIC MECHANICAL LOAD TEST INFORMATION AND CLAMP INSTALLATION INFORMATION PLEASE VISIT: [WWW.S-5.COM](http://WWW.S-5.COM)**

MATERIAL: 6005A T61	<div data-bbox="1624 1220 1780 1316"> <p>The Right Way!</p> </div> <div data-bbox="1915 1220 2139 1332"> <p>METAL ROOF INNOVATIONS, LTD. 8655 TABLE BUTTE RD COLORADO SPRINGS, CO 80908 719-495-0518 719-495-0045(FAX)</p> </div>		
EST ASSEMBLY WEIGHT 0.176 lbs	TITLE RibBracket I [CCD]		
SUPPLIED HARDWARE: M8-1.25 Flange Nut (4x) 1/4"-1" Stainless Steel Self-Tapping Screw with 5/16" Hex Head	DRAWING NO. HI-A-0-A	DRAWN BY Jesse Winternitz	DATE 7/1/2019
SCALE: 1:2	<p>S-5!® PRODUCTS ARE PROTECTED BY MULTIPLE U.S. PATENTS INCLUDING 5,228,248, 5,983,588 AND 6,164,033 (OTHERS ISSUED AND PENDING). EUROPEAN PATENTS ARE ALSO APPLIED FOR AND PENDING UNDER THE PATENT COOPERATION TREATY WITH DIVISIONAL FILING RIGHTS RETAINED. METAL ROOF INNOVATIONS, LTD. (LICENSOR OF S-5!® TECHNOLOGY) AGGRESSIVELY PROSECUTES PATENT INFRINGEMENT.</p>		
WEIGHTS: Bracket: 0.0890 lbs Screw: 0.0180 lbs Nut: 0.0145 lbs			